

Images herein attached are exemplifying and do not represent the whole Carel's portfolio

E2VSTA031* - E2VSTA032* - E2VSTA037*

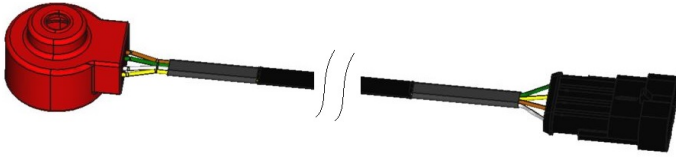

E2VSTAS23*



E2VSTA020*

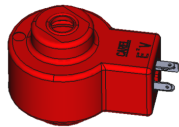

E2VCAB**00



E2VCAB**10



E2VCABS*U0



For further details see products technical leaflets available on our website or contact us at carel@carel.com

STATOR

| EEV Family | Code | Unipolar | Bipolar | Stator IP | Cable | Length [m] | Terminal | Package |
|------------|------------|----------|---------|-----------|-------|------------|-----------|---------|
| E2V | E2VSTA0310 | X | | 67 | YES | 1 | JST | single |
| | E2VSTA0311 | X | | 67 | YES | 1 | JST | multi |
| | E2VSTA0320 | X | | 67 | YES | 2 | JST | single |
| | E2VSTA0321 | X | | 67 | YES | 2 | JST | multi |
| | E2VSTA0330 | X | | 67 | YES | 0.3 | Superseal | single |
| | E2VSTA0331 | X | | 67 | YES | 0.3 | Superseal | multi |
| | E2VSTA0370 | X | | 67 | YES | 0.7 | JST | single |
| | E2VSTA0371 | X | | 67 | YES | 0.7 | JST | multi |
| | E2VSTA0200 | | X | 67 | NO | - | - | single |
| | E2VSTA0201 | | X | 67 | NO | - | - | multi |
| | E2VSTAS220 | | X | 69K | YES | 2 | Free | single |
| | E2VSTAS221 | | X | 69K | YES | 2 | Free | multi |
| E2VSTAS230 | | X | 69K | YES | 0.3 | Superseal | single | |
| E2VSTAS231 | | X | 69K | YES | 0.3 | Superseal | multi | |
| E3V | E3VSTA0311 | X | | 67 | YES | 1 | JST | multi |
| | E3VSTA0321 | X | | 67 | YES | 2 | JST | multi |
| | E3VSTA0331 | X | | 67 | YES | 0.3 | Superseal | multi |
| | E3VSTA0351 | X | | 67 | YES | 0.5 | Superseal | multi |
| | E3VSTA0200 | | X | 67 | NO | - | - | single |
| E4V & E7V | E4VE7VSTA0 | | X | 67 | NO | - | - | single |
| | E4VE7VSTA1 | | X | 67 | NO | - | - | multi |
| E5V | E5VSTA0000 | | X | 67 | NO | - | - | single |
| E6V | E6VSTA0000 | | X | 67 | NO | - | - | single |
| | E6VSTA0001 | | X | 67 | NO | - | - | multi |

CABLES

| Code | Unipolar | Bipolar | Shield | Length [m] | Stator | Driver |
|------------|----------|---------|--------|------------|-----------|--------|
| E2VCAB0300 | | X | NO | 3 | Direct | Free |
| E2VCAB0310 | | X | NO | 3 | Superseal | Free |
| E2VCAB0600 | | X | NO | 6 | Direct | Free |
| E2VCAB0610 | | X | NO | 6 | Superseal | Free |
| E2VCAB0900 | | X | NO | 9 | Direct | Free |
| E2VCAB0910 | | X | NO | 9 | Superseal | Free |
| E2VCABS300 | | X | YES | 3 | Direct | Free |
| E2VCABS310 | | X | YES | 3 | Superseal | Free |
| E2VCABS600 | | X | YES | 6 | Direct | Free |
| E2VCABS610 | | X | YES | 6 | Superseal | Free |
| E2VCABS900 | | X | YES | 9 | Direct | Free |
| E2VCABS910 | | X | YES | 9 | Superseal | Free |
| E2VCABSA50 | | X | YES | 15 | Direct | Free |
| E2VCABS3U0 | X | | YES | 3 | Superseal | JST |
| E2VCABS6U0 | X | | YES | 6 | Superseal | JST |
| E2VCABS9U0 | X | | YES | 9 | Superseal | JST |

OTHER ACCESSORIES

| General code | Brief description |
|--------------|--|
| E*VMAG**** | Magnet tool for manually driving the valve |
| E*VATT**** | Spare actuator for demountable valves |
| E*VFIL**** | AISI 304 filters, 150um and 500um of various diameters |
| E*VSGH**** | Spare sight glass for demountable valves |
| E*VORI**** | Spare o-rings for demountable valves |
| E*VCON**** | Various cables connectors |
| E*VNUT**** | Tightening nuts for stators |